



Charlestowne Estates I Neighborhood Association Spring 2012 Newsletter

CharlestowneEstates1.wordpress.com; facebook.com/charlestowne1



Hello Neighbor!

It has been 1 year since the inception of our Neighborhood Association and we can't think of a better way to celebrate than installing a new front entrance. As the gateway to our neighborhood, we can all take pride in the community effort that has gone into making this renewal possible.

Please visit **CharlestowneEstates1.wordpress.com** for information about the Association, your zone captains, a neighborhood directory and more.

Please note that it is election time and we ask that you nominate yourself or a neighbor to serve in the upcoming year. We'd like to thank our current board members, Zone Captains and committee members for their hard work and dedication: Will Moore (President), Angel Postell (Vice President), Jana Isom (Secretary, Zone Captain), Pat Caldwell (Treasure, Zone Captain), Jennifer Buddin, Colleen Condon, Carol Fougrousse, Meredith Griffin, Anne Hawkes, Sarah Moore, Tammy Nates, Arnold Postell, Rocky Quinn and Anna Seago .

- The Charlestowne Estates Neighborhood Association

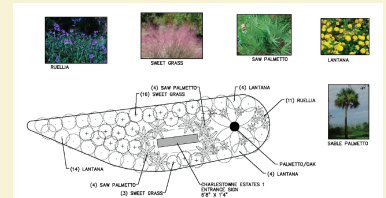

Planting Day!

Please join us to plant the new front entrance bed.

Saturday, April 28; 9 am

Bring gardening gloves, bug spray and water. Meet at front entrance.



Please keep an eye out for an invitation to the dedication in May!



CALL FOR NOMINATIONS!

Please complete and email to Charlestowneestatesone@gmail.com or return to your Zone Captain.

Thank you to the current Executive Board for their service and commitment to our neighborhood. With your help, we can continue the hard work and efforts begun this year. Please make your nominations for the following and indicate your interests below by placing a check next to all that apply.

Executive Board

President: _____ Vice President: _____
Secretary: _____ Treasurer: _____

- | | | |
|--|--|---|
| <input type="checkbox"/> Garden Committee | <input type="checkbox"/> Social/Events Committee | <input type="checkbox"/> Communications Committee |
| <input type="checkbox"/> Safety/Services Committee | <input type="checkbox"/> Zone Captain | <input type="checkbox"/> General Volunteer |

Neighborhood Notes

Yard of the Month

The monthly honor is being awarded again now that it is Spring. The April Yard of the Month winner is 1650 Culpepper!

Be a Good Neighbor

We're all committed to making our community a safe, attractive and friendly place to live. If you have an issue (trash, pet waste, etc.) to address with a neighbor, our policy is:

- 1) Talk with the neighbor about the issue.
- 2) If a resolution cannot be agreed upon, contact the proper city or county entity.

Pick Up After Your Pet

"Pet waste is litter. Pet litter is full of bacteria, parasites and other harmful organisms. Improperly disposed of pet waste washes into local water systems impacting us all. If you observe a violation of this ordinance please call 843.577.7434 and inform Animal Control.

Trash Day Reminder

Please note that trash/trash piles are to be put on the street as close to trash day as possible. Charlestowne Estates 1 trash day is Wednesday for both trash and yard trash. Remember: all yard refuse must be in paper bags; plastic bags are no longer accepted.

Crime Report

The week of April 9, a cobalt blue with silver accents Gary Fisher Mountain Bike was taken from a carport on Culpepper Circle. If you have any information or have seen any suspicious activity, please alert the Charleston Police Department Liaison for Our Area: Lt. David Young: 843-323-7006 or the CPD at 843-577-7434.

Race the Landing

This 5K Series invites you to run the trails at Charles Towne Landing and features awards and uniquely themed post-race parties. Come enjoy friendly competition, family fun, and celebrate the history and culture of our beautiful lowcountry. May 3 & 10; June 7 & 14; July 19; www.RacetheLanding.com

Ashem Farm

Mrs Emily Ravenel Farrow bequeathed her beloved Ashem Farm, located next to Charles Towne Landing, to the Lowcountry Open Land Trust who transferred it to the Charleston County Park and Recreation Commission with a commitment to maintain the site as a public park for all to enjoy. This is wonderful news for our neighborhood! To find out more: <http://www.ashemfarm.com/>



Savings & Deals

We have negotiated a landscapers price on pinestraw and free delivery to your yard!

Delivery is scheduled for Friday May 4th.

Please email
Charlestowneestatesone@gmail.com
no later than May 1st
to place your order:

Short needle = \$3.50 per bale
Long needle = \$4.35 per bale
(larger and lasts longer
before decomposing)

We also have a negotiated rate for a tree service. If you would like a quote, please email:
Charlestowneestatesone@gmail.com



Join the Association

Please complete and email to Charlestowneestatesone@gmail.com or return to your Zone Captain.

We hope every neighbor will become a part of the Association. Dues are just \$15 for the year. If you have not already joined, please complete the following. Thank you for your support!

NAME: _____

ADDRESS: _____

PHONE: _____ EMAIL: _____

Are you interested in volunteering? _____

